

Independence™**SEALED RECHARGEABLE LEAD-ACID****B A T T E R I E S**

YUASA
NP65-12
NP65-12FR

12V, 65.0Ah**Specifications****NOMINAL VOLTAGE:** 12V**NOMINAL CAPACITY:**

20 hr. rate of 3.25A to 10.50V 65.0Ah

10 hr. rate of 6.05A to 10.50V 60.5Ah

5 hr. rate of 11.05A to 10.20V 55.2Ah

1 hr. rate of 39.0A to 9.60V 39.0Ah

WEIGHT (approx.): 50 pounds (22.7 kgs.)**ENERGY DENSITY (20 hr. rate):**

1.26 WH/cubic inch (76 WH/liter)

SPECIFIC ENERGY (20 hr. rate):

15.5 WH/pound (34 WH/kg)

INTERNAL RESISTANCE OF CHARGED BATTERY:

5 milliohms (approx.)

MAXIMUM DISCHARGE CURRENT**WITH STANDARD TERMINALS:**

800 amperes

MAXIMUM SHORT-DURATION**DISCHARGE CURRENT:**

800 amperes

OPERATING TEMPERATURE RANGE:**CHARGE** 5°F to 122°F

(-15°C to 50°C)

DISCHARGE -4°F to 104°F

(-20°C to 60°C)

CHARGE RETENTION (shelf life) at 68°F (20°C):**1 month** 97%**3 months** 91%**6 months** 85%**LIFE EXPECTANCY:****STANDBY USE** 3 to 5 years**CYCLE USE (approx.):****100% depth of discharge** 250 cycles**50% depth of discharge** 550 cycles**30% depth of discharge** 1200 cycles**SEALED CONSTRUCTION:**

Can be operated in any position without leakage.

STANDARD TERMINAL:

Bolt Fastened Terminal

HOUSING MATERIAL: ABS Resin**OPTIONAL:** Container and cover made from

Flame Retardant ABS (UL94-V0/L.O.I.>28%)

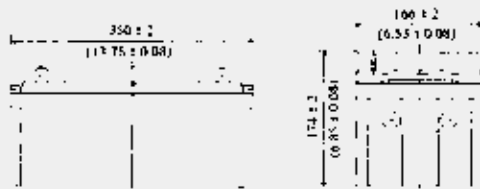
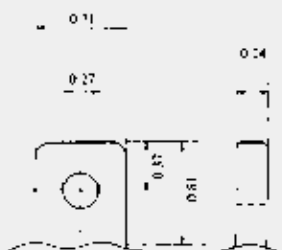
DIMENSIONS**TERMINAL**

INCH = MM

0.24 6

0.27 7

0.37 9.5

0.71 18

0.81 20.5



RECOGNIZED BY UL, File No. MH 12970

DISCHARGE CHARACTERISTIC CURVES AT 20°C (68°F)

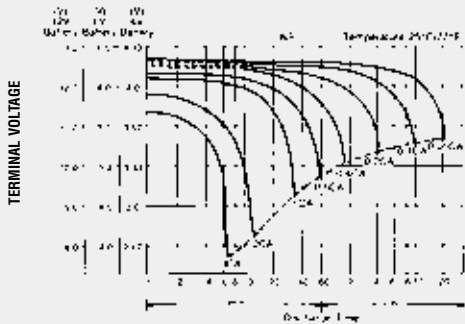

TEMPERATURE EFFECTS IN RELATION TO BATTERY CAPACITY

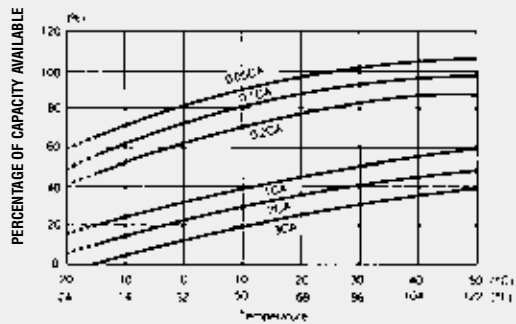

SELF DISCHARGE CHARACTERISTIC

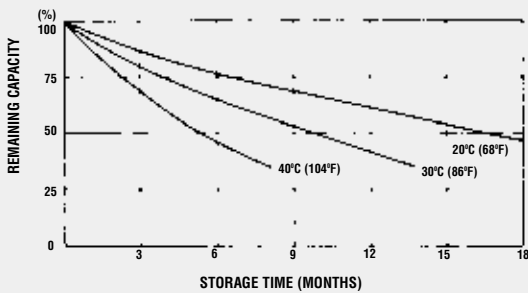

OPEN CIRCUIT VOLTAGE VS REMAINING CAPACITY

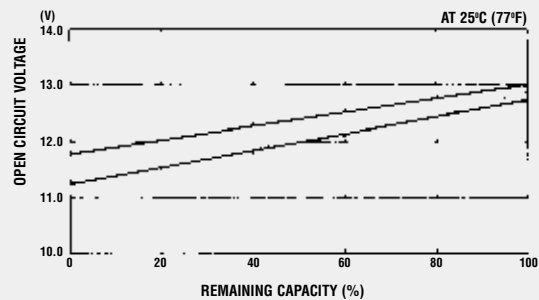

CYCLE SERVICE LIFE IN RELATION TO DEPTH OF DISCHARGE

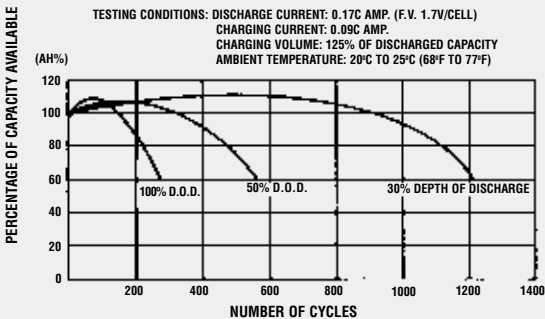

TRICKLE (FLOAT) USE LIFE CHARACTERISTICS

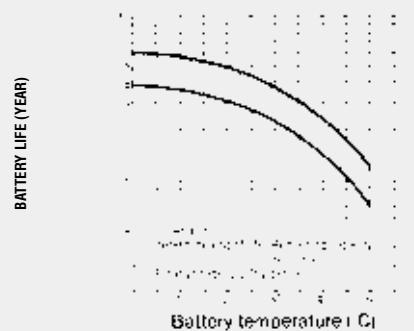

When the battery will be used by the current in excess of 3C, consult with EnerSys Inc. prior to use.

CHARGING METHODS (At 20°C) Cycle use: Maximum charging current 16.25A
Charging voltage 14.4 to 15.0V

Standby use: Float charging voltage 13.50 to 13.80V

- CAUTION**
- Avoid short circuit
 - Do not charge in a sealed container.

Represented by:

When ordering new batteries, also remember to properly recycle your old lead batteries. Federal and state regulations require lead-acid batteries be recycled. EnerSys' nationwide service organization can arrange pickup, transportation to and recycling at any one of our company affiliated smelters. Call 1-800-972-7372 for more information.



Sales Offices

Eastern Region: 201-964-0118 • 1-800-962-1287
FAX 201-964-0720

Western Region: 562-949-4266 • 1-800-423-4667
FAX 562-949-5527

Corporate Office: P.O. Box 14145, Reading, PA 19612-4145
FAX 610-372-8613

Visit us on the web at: www.enersysstationary.com

Please check our website for literature updates

Printed in USA

