

SEALED RECHARGEABLE LEAD-ACID

B A T T E R I E S



YUASA NP1.2-6 NP1.2-6FR

6V, 1.2Ah

Specifications

NOMINAL VOLTAGE: 6V

NOMINAL CAPACITY:

- 20 hour rate of 0.06A to 5.25V 1.2Ah
- 10 hour rate of 0.11A to 5.25V 1.1Ah
- 5 hour rate of 0.20A to 5.10V 1.0Ah
- 1 hour rate of 0.70A to 4.80V 0.7Ah

WEIGHT (approx.) 0.66 pounds (0.30 kgs.)

ENERGY DENSITY (20 hr. rate):

0.40 WH/cubic inch (55 WH/liter)

SPECIFIC ENERGY (20 hr. rate):

10.9 WH/pound (24 WH/kg)

INTERNAL RESISTANCE OF CHARGED BATTERY:

60 milliohms (approx.)

MAXIMUM DISCHARGE CURRENT WITH STANDARD TERMINALS:

40 amperes

MAXIMUM SHORT-DURATION DISCHARGE CURRENT:

45 amperes

OPERATING TEMPERATURE RANGE:

CHARGE 5°F to 122°F
(-15°C to 50°C)

DISCHARGE -4°F to 140°F
(-20°C to 60°C)

CHARGE RETENTION (shelf life) at 68°F (20°C):

- 1 month 97%
- 3 months 91%
- 6 months 85%

LIFE EXPECTANCY:

STANDBY USE 3 to 5 years

CYCLE USE (approx.)

- 100% depth of discharge 250 cycles
- 50% depth of discharge 550 cycles
- 30% depth of discharge 1200 cycles

SEALED CONSTRUCTION:

Can be operated in any position without leakage.

STANDARD TERMINAL:

Quick Disconnect .187

HOUSING MATERIAL: ABS Resin

OPTIONAL: Container and cover made from Flame Retardant ABS (UL94-VO/L.O.I.>28%)

Dimensions

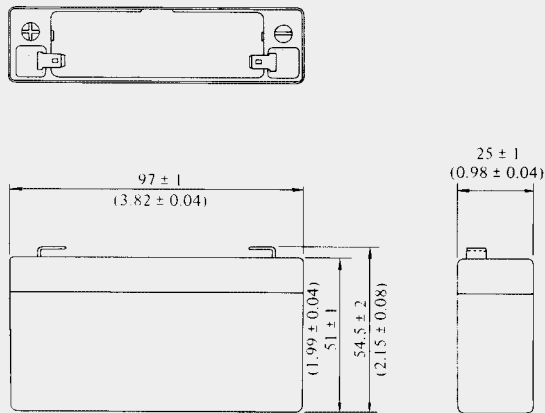

DIMENSIONS: MM (INCHES)

Terminal

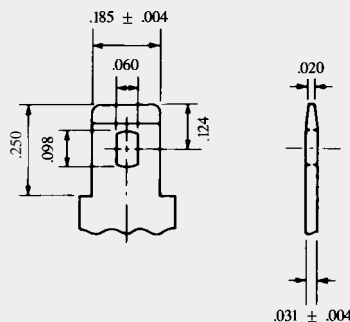

INCH = MM

.250	6.35
.185	4.70
.124	3.15
.098	2.49
.060	1.52
.031	0.79
.020	0.51
.004	0.10



RECOGNIZED BY UL, File No. MH 12970

DISCHARGE CHARACTERISTICS CURVES AT 25°C (77°F)

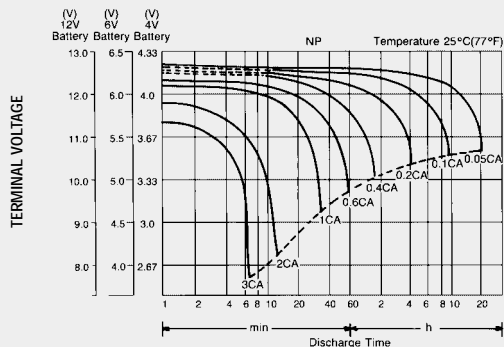

TEMPERATURE EFFECTS IN RELATION TO BATTERY CAPACITY

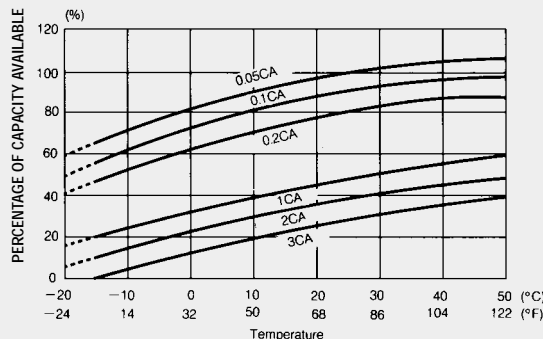

SELF DISCHARGE CHARACTERISTICS

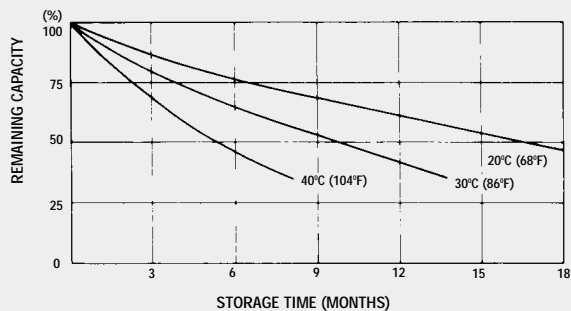

OPEN CIRCUIT VOLTAGE VS REMAINING CAPACITY

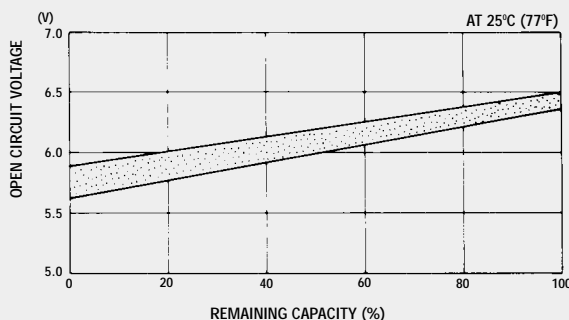

CYCLE SERVICE LIFE IN RELATION TO DEPTH OF DISCHARGE

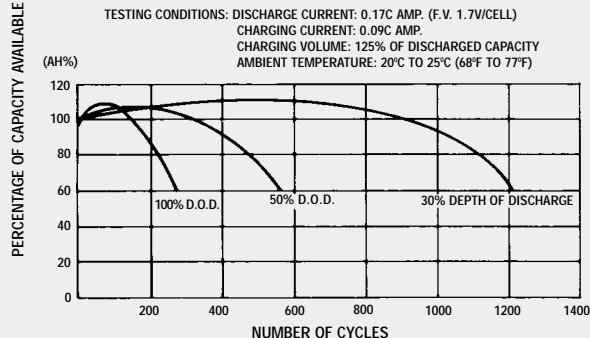

FLOAT SERVICE LIFE

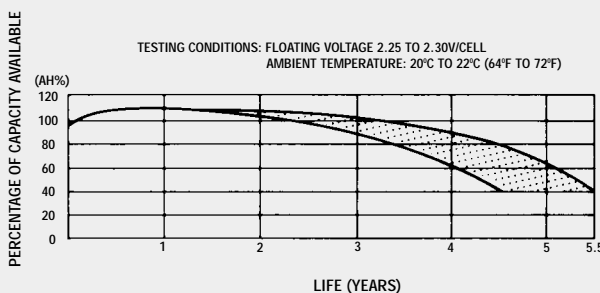

When the battery will be used by the current in excess of 3C, consult with EnerSys Inc. prior to use.

CHARGING METHODS (At 20°C) Cycle use: Maximum charging current 0.30A

Charging voltage 7.2 to 7.5V

Standby use: Float charging voltage 6.75 to 6.90V

CAUTION

- Avoid short circuit
- Do not charge in a sealed container.

Represented by:

When ordering new batteries, also remember to properly recycle your old lead batteries. Federal and state regulations require lead-acid batteries be recycled. EnerSys' nationwide service organization can arrange pickup, transportation to and recycling at any one of our company affiliated smelters. Call 1-800-972-7372 for more information.



Global Headquarters: P.O. Box 14145, Reading, PA 19612-4145
 1-610-208-1991 • 1-800-538-3627
 FAX 1-610-372-8613

US Sales Offices
 Eastern Region: 1-201-964-0118 • 1-800-962-1287
 Western Region: 1-562-949-4266 • 1-800-423-4667

Regional Sales Offices
 EnerSys Canada: 1-905-790-1212
 ESB de Mexico SA DE: 52-8-329-6405

EnerSys Inc. has locations worldwide to serve your needs; for additional information please visit our website at www.enersysinc.com or contact us at 1-800-538-3627.